



Kensington Church Street

Notting Hill, W8 4DP

£450 Per Week

This is an excellently located one double bedroom apartment on the second floor (with lift) of a secure building moments from trendy Notting Hill and within easy walking distance to Hyde Park and Kensington High Street. The property comprises of, reception/dining room with access to a large balcony, double bedroom with fitted wardrobes, separate kitchen, shower/wc (washing machine) and entrance hall. The property also benefits from having wooden flooring throughout with ample storage. The property is offered furnished and will be available from 6th August for long let only.

An ideal flat for young professional.

- One Double Bedroom
- Second Floor
- Reception
- Separate Kitchen
- Large Balcony
- Wooden Floor
- Close to Hyde Park., Notting Hill

Viewing

Please contact our Messila Residential Office on 020 7586 6699 if you wish to arrange a viewing appointment for this property or require further information.



1



1



1



C

Floor Plan

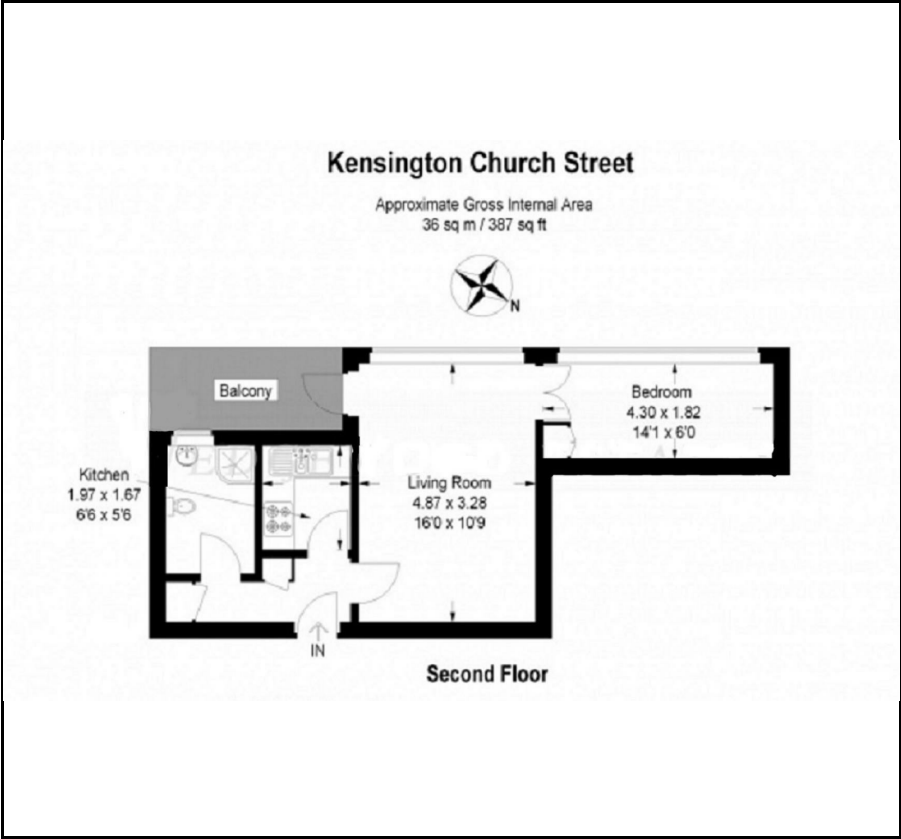

Area Map



Energy Efficiency Graph

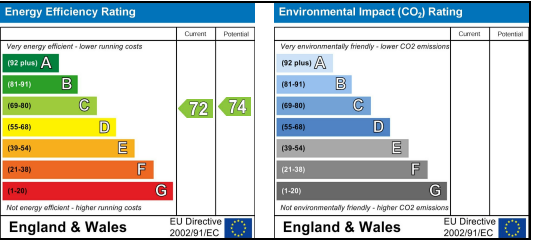

These particulars, whilst believed to be accurate are set out as a general outline only for guidance and do not constitute any part of an offer or contract. Intending purchasers should not rely on them as statements of representation of fact, but must satisfy themselves by inspection or otherwise as to their accuracy. No person in this firms employment has the authority to make or give any representation or warranty in respect of the property.